

123456

A

B

C

D

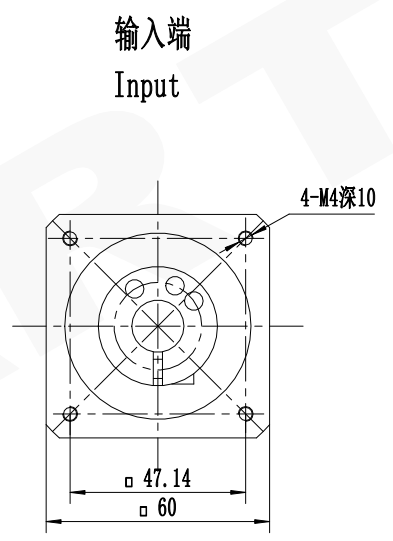
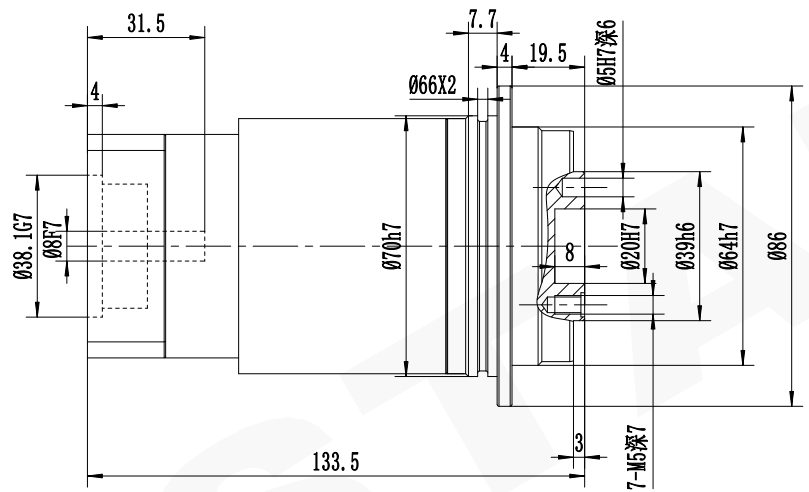
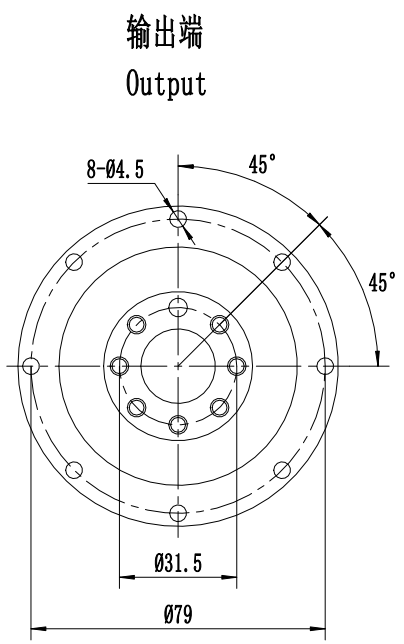

A

B

C

D

减速比 (Ratio i)	60	64	80	100	120	160	200	256	320	512
额定承载扭矩 (Rated load torque) Nm	65	65	65	65	65	65	60	65	60	45
最大加速力矩 (Max. acceleration torque) Nm	117	117	117	117	117	117	108	117	108	81
急停扭矩 (Emergency stop torque) Nm	195	195	195	195	195	195	180	195	180	135

未注线性尺寸极限偏差 Unmarked tolerance	
0.5-3	±0.2
3-6	±0.3
6-30	±0.5
30-120	±0.8
120-400	±1.2
400-1000	±2

精密行星减速机技术参数						精密行星减速机 Precision Planetary Gear Boxes	
容许最大径向载荷 (Max. radial load)	3150N	空载力矩20℃ (No-load torque)		≤ 0.1Nm			
容许最大轴向载荷 (Max. axial load)	2400N	润滑 (Lubrication)		合成润滑脂 (Synthetic grease)			
额定输入转速 (Nominal input speed)	3000r/min	使用环境温度 (Operation temperature)		-15℃~+90℃			
最大输入转速 (Max input speed)	6000r/min	使用寿命 (Service life)		≥20000h		AD064L3-i-P2-0P2	
噪音 (Noise)	≤ 60db	防护等级 (Protection grade)		IP54		8-24-38.1-□47.14-M4	
回程间隙 (Backlash)	7arcmin		AD系列		Tel/电话: 0533-6288333 6288444		A. AD. 064.
			P2 L3		Fax/传真: 0533-6288411		
					Web/网址: www.newstart.cn		

123456